

REG	STATE	PROJECT	SHEET NO.	TOTAL SHEETS
3	D.C.	STP - 1116 (27)	104	206

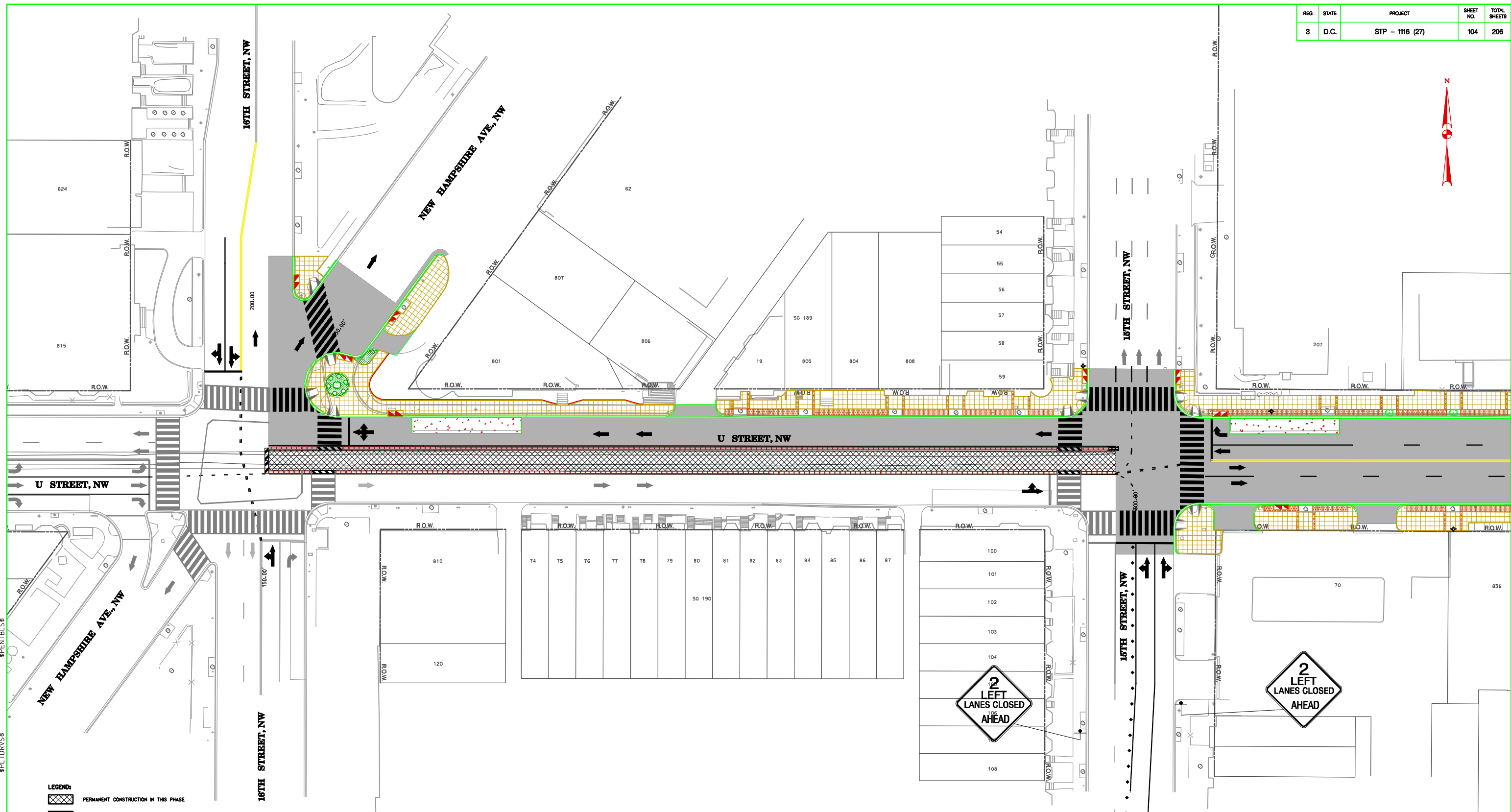

L:\U_Street\TWP\U_Street\U_Street.dgn
 Wednesday, June 03, 2009 AT 09:08 AM
 \$PENTBL\$
 \$PLTDRVS\$

- LEGEND:**
- PERMANENT CONSTRUCTION IN THIS PHASE
 - PERMANENT CONSTRUCTION IN PHASE (LATER)
 - PERMANENT CONSTRUCTION COMPLETED IN PREVIOUS PHASE
 - PORTABLE PCC TRAFFIC BARRIERS
 - FLAGGER
 - TYPE II BARRICADES
 - TRAFFIC DRUMS
 - CONSTRUCTION ZONE ATTENUATOR
 - TRAFFIC FLOW ARROW
 - SIGN LOCATION SYMBOL
 - SIG. ARROW BOARD

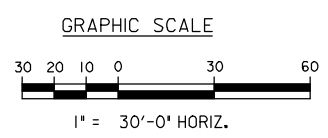

LDICA
 Legion Design / Campbell & Associates
 Consulting Engineers • Washington, D.C.

NO.	DESCRIPTION	NAME	DATE
REVISIONS			

D.C. DEPARTMENT OF TRANSPORTATION
 INFRASTRUCTURE PROJECT MANAGEMENT ADMINISTRATION
 PROJECT MANAGEMENT DIVISION

RESURFACING / REHABILITATION
 OF U STREET, N.W.
 FLORIDA AVENUE TO 9TH STREET

MAINTENANCE OF TRAFFIC PLANS
 15TH STREET TO 16TH STREET

PROJECT ENG. <u>RMJ</u> DESIGNED BY <u>RMJ/MLC</u> CHECKED BY <u>MEW/AE/JDC</u> DRAWN BY <u>RMJ/GUL/GSS</u> PROJECT MGR. <u>MEW</u>	DIVISION CHIEF
DATE _____	
FILE _____	
SHEET 104 OF 206	